

Full-height stud wall hides the toilet area and showering space



SUITE DREAMS in South London

Five Sextillion explains how it transformed an ageing and poorly executed main en suite for a young professional couple into their dream bathroom

This was a large room where every possible configuration was explored before putting forward the most optimum layout to our client.

We created a full-height stud wall to divide the room in two – a large open area for double basins, a freestanding bath and plenty of space to move around in, then further divided the smaller area into a generous-sized shower and a private toilet zone.

The beautiful rosette ceiling pendant moulding was central to the room, so we ensured that the bath and basin unit followed this centre line. Two large all-electric ladder towel warmers were positioned within easy access of both shower and bath.

We installed under-tile heating for extra warmth and luxury, including underneath the tiled shower floor to help dry the wet area after use.

We made sure there was plenty of storage – both concealed and exposed – within the basin console table and bespoke pieces of joinery (behind the WC and next to the window), as well as plenty of ledge space for toiletries and decorative objects.

In terms of materials and finishes, we paired a matt white WC, basins and bath with brushed steel brassware featuring oversized cylindrical handles, along with matching finish accessories.

For the tiling, we combined natural large-format tiles in the shower, WC and bath floor and walls, narrow glossy white ceramic tiles for contrast and interest over the entire back wall to the shower and WC, which run across the back of the alcoves as a feature. These are further accentuated by concealed LED lighting strips within the roof of the recesses.

On the main bathroom floor, we laid planks of a cool

grey wood-effect porcelain tile, to add to the natural look while being extremely practical. We also created a backdrop of soft blue wallpaper behind the basins.

We chose a taupe fabric with a gentle sheen for the roman blind to add a touch of softness to the space and for privacy at night and combined this with vertical bands of a classical trimming – a nod to the original architectural details of the property.

Although we constructed a full-height central bath wall, the dividing wall from the shower to the WC stopped short of the ceiling by 450mm. This allowed more natural light into the shower.

We ensured the design incorporated task and ambient lighting, including illuminated basin mirrors, downlighters above the shelving in the tall cabinet and a cluster of globe pendants staggered in height and making the bath more of a focal point.



Globe pendant lights help make the bath a focal point of the room



About Five Sextillion



Five Sextillion was established five years ago by husband-and-wife team Adrian and Sokum Hyland-Smith to offer clients a turnkey interior design service that ensures every element from the design through to installation is delivered to the highest standards. Their previous experience in design and the supply of luxury interiors brings a wealth of product knowledge to deliver both outstanding design and longevity. For those clients looking for fine attention to detail, or wishing to push the design possibilities, is where it aims to make the difference, alongside exceptional customer service.

THE PROPERTY

A large Victorian terraced house with high ceilings and period mouldings in Clapham South, London. The property had been previously extended on the ground floor and the bathrooms were not only ageing, but were also poorly executed, which meant they were not functioning as well as they could be.

THE CLIENTS

Busy professionals with two young children who moved into the property shortly after having their second child. They approached us for a turnkey design, supply and installation service for their principal en-suite bathroom and bedroom.

THE BRIEF

Our clients asked us for a design that provided modern but elegant style to complement a period property with a warm, natural colour scheme and open to an injection of colour. The big shower head delivered a lot of water, however the standard shower waste struggled to drain quickly. Our clients wanted a large shower with generous-size shower head and hand-shower and open to walk-in and a freestanding bath that would be practical in terms of size. Storage in the original bathroom was limited so they wanted us to maximise open and enclosed storage in our design. ▶

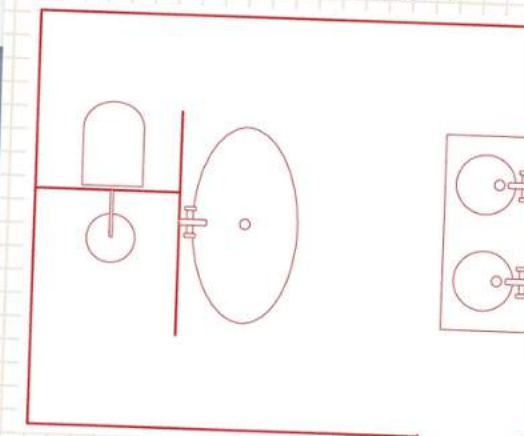

CASE STUDY | Five Sextillion



Soft blue wallpaper adds a touch of colour to the room

BATHROOM DETAILS

Overall project cost:
£45,000

Designer: Sokum Hyland-Smith
Basin: Villeroy & Boch Artis Basin
tap: Fukasawa 3-hole wall-mounted basin mixer
Vanity unit: Duravit Luv vanity and console top
Shower fittings: Fukasawa head and arm, hand shower
Bath: Victoria & Albert Barcelona freestanding bath
Bath taps: Fukasawa wall-mounted bath taps
WC: West One Bathrooms Primo matt WC and seat, Fukasawa flush plate
Heated towel rail: Vogue UK Vivid
Mirror: Alape mirror with dimmable light

INSTALLER COMMENTS

A large amount of planning was carried out to enable an exceptional level of detailing throughout. All visible tile to tile edges have been meticulously mitred to ensure a seamless, subtle finish. The positioning of grout lines and product placement have been well considered and because the ceiling was not square to the wall, when we created the opening for the large, recessed mirror, we made the top of the mirror opening parallel to the ceiling. And because the cut mirror would disguise this, it meant that we did not have to interfere with the decorative mouldings.

The linear shower drain was located to the far right between the three walls for the most effective drainage, and the discreet gentle gradient across the full 2m shower floor ensures that any droplets of water landing near the entrance of the shower will run off towards the drain. 



The shower area is concealed behind the stud wall

HERITAGE®
BATHROOMS



Design with Heritage

Our timeless classics, Dorchester and Granley are the perfect choice when creating elegant and luxurious bathrooms. With beautifully crafted basins in multiple sizes, to pans in high and low level options – there is something for every bathroom. With industry-leading service and guarantees, we're making it easier than ever for you to Design with Heritage.



See our five new looks